



P.O. Box 535596 • Grand Prairie, Texas 75053
Toll-free 800-775-7124

www.lucidaudio.com

PREMIER ITC HEARING AMPLIFIER

powered by  Lucid



PRODUCT MANUAL



YOUR HEARING AMPLIFIERS

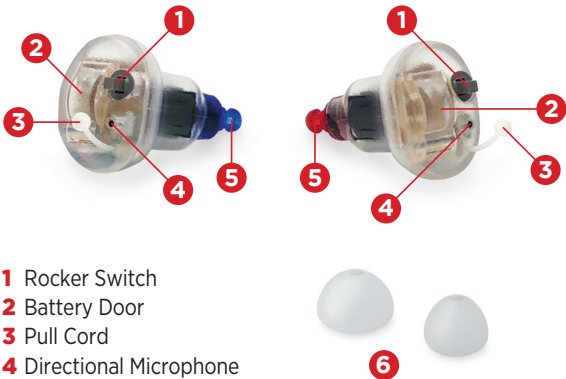

- 1 Rocker Switch
- 2 Battery Door
- 3 Pull Cord
- 4 Directional Microphone
- 5 Sound Port
- 6 Tips

Red Sound Tip - Right Hearing Instrument
Blue Sound Tip - Left Hearing Instrument

INCLUDED ACCESSORIES



Your hearing amplifiers are shipped with a variety of accessories, a sampling pictured above, including the following:

- Storage Case
- Cleaning Tool with Brush
- Batteries
- Battery Holder

If you have any questions about the use of these accessories please contact your hearing care professional or our Customer Service team at **1-800-775-7124**.

BATTERY INSERTION

The Premier ITC hearing amplifier is powered by a size 10 battery. We recommend using a zinc-air type battery for the best performance. To insert a zinc-air type battery, remove the adhesive label and wait thirty seconds for air to activate the battery. Wipe any moisture off the battery surface. Open the battery door and with the positive side up, insert battery into the battery door. To remove, open the battery door and lift the battery out of the battery door. The brush has a magnet on the end to assist with placing the battery in the holder and removing the battery.



When your battery is low and needs replaced you will hear the low battery voice prompt. The prompt will be repeated until the battery is changed. The low battery voice prompt will be repeated every 15 - 20 minutes.

POWER & VOLUME CONTROL

After inserting the battery, close the door completely to turn the unit on. To turn the unit off, simply open the battery door partially. To help prolong battery life, open the battery door each time you remove your hearing amplifiers.

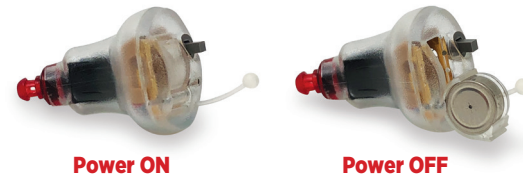

Once the battery door is completely shut, you will hear the unit turn on. To adjust the volume either higher or lower use the dual function Rocker Switch. You will press the Rocker Switch either up or down to increase or decrease the volume. You will hear a quick double tone indicating the volume has been adjusted. When you hear a single tone, this indicates you have reached the maximum or minimum hearing volume level. Always ensure the volume is at a comfortable listening level.

INSERTING HEARING AMPLIFIERS



Inserting your hearing amplifiers for the first time can be challenging. There can be feedback (whistling) if your hearing amplifiers are not fully inserted. We suggest you practice inserting them without the battery until you have perfected this process.

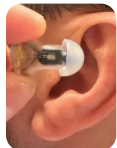

Follow these steps to insert your hearing amplifier:

- 1 Place one of the tips on each of the hearing amplifiers by pushing the tips down. Make sure tips are secure.
- 2 Grasp unit between your thumb and forefinger.
- 3 Gently insert the hearing amplifier into your ear canal. When positioned correctly it is practically invisible and only the pull cord is visible.

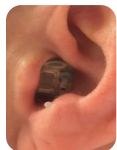
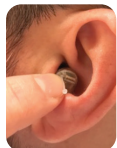

To remove the aid, grasp the knob on the end of the nylon pull cord and gently pull the instrument from the ear canal.

You may change the tip for a more comfortable fit. To change tips, gently pull tips off of the unit and replace with the other size.

PROGRAM SELECTION

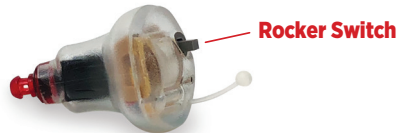

Your hearing amplifiers feature two listening programs.

Program 1 (Lucid) is automatically selected when the hearing amplifier is turned on and will amplify higher frequency sounds. This is the best choice for most listening situations.

Program 2 (Music / Concert) is best when listening to music or attending a concert where low frequency sounds need to be amplified.

To change programs simply press the Rocker Switch up or down and hold for 2 seconds. A two-beep prompt will announce the program change. Press and hold again to cycle through the programs.

You should evaluate the different programs for each listening environment to determine which is the best, most comfortable sound.

CLEANING

The most common cause of instrument failure is wax buildup and it is the easiest to avoid. By wiping your hearing amplifiers with a soft, dry cloth every day and carefully removing any traces of wax and debris, you will reduce wax buildup. A brush is provided to further assist you in cleaning your instrument. Use the brush provided to enhance your cleaning by lightly brushing the sound ports. It is important to keep your hearing amplifiers as clean as possible to maintain maximum performance and durability.

To clean your ear tips, disconnect them from the hearing amplifier and then wash in lukewarm water with a mild detergent. Dry thoroughly before reconnecting.

Remember to remove the hearing amplifiers before showering or bathing to avoid water damage to the devices.

BATTERY SAFETY INFORMATION

HEARING AMPLIFIER BATTERIES ARE DANGEROUS IF SWALLOWED

Keep out of the reach of children or anyone who may accidentally swallow them. Never put batteries in your mouth for any reason. Do not store batteries in pill containers where they may be mistaken for medication and swallowed. Use batteries recommended by your hearing care professional. Batteries of low quality may leak and cause bodily harm. Batteries with incorrect voltage may cause damage to your device. Never attempt to recharge your batteries. They may explode and cause serious injury. Do not expose your batteries to heat, such as an open flame, microwave, or oven. There is a risk they will explode and cause serious injury. Please discard old batteries in a safe place.

Visit <http://www.poison.org/prevent/battery.asp> to learn more important information about battery safety.

If a battery or hearing instrument is swallowed, see a doctor immediately and call the National Capital Poison Center at 202-625-3333.

GENERAL INSTRUMENT CARE

Your amplifiers are delicate, precision electronic devices and require special care and handling that should be provided to such devices. Please read and follow the listed precautions to ensure quality performance and long instrument life.

- Remove batteries when hearing amplifiers will not be in use for prolonged periods of time.
- Do not throw or drop your amplifiers.
- Do not immerse hearing amplifiers in liquid or water
- Do not wear during bathing, showering or swimming
- Store out of the reach of children and pets.
- Do not expose amplifiers to excessive heat, such as stove top, microwave, dash board of a hot car, or hair dryer.
- Do not expose the amplifiers to chemicals such as hair spray, insect repellent, perfume, or cosmetics.
- Do not use the product with higher volume for a long period of time, in order to avoid hearing damage. Stop using if discomfort occurs.
- Do not disassemble the device
- To avoid possible electromagnetic radiation, the devices should be removed in any high frequency, heat treatment or operation, radiotherapy and strong magnetic field environments.
- Please avoid use in a potentially explosive or dangerous situation.
- Only qualified accessories should be used with this device.
- Take off the hearing amplifier at night.
- Please keep the surface of hearing amplifiers clean, clean wax build up in tips.
- Please use the Rocker Switch correctly, avoid excessive force as far as possible.

Special Note. Your hearing amplifiers are built with the finest quality materials. However, in rare instances an individual may experience sensitivity to the materials used. Please consult with your physician if you exhibit any signs of skin irritation, allergic reaction, or accelerated accumulation of cerumen (wax).

TROUBLESHOOTING GUIDE

SYMPTOM	CAUSE	SOLUTIONS
Feedback, Whistling, Chirping or Whirling	<ul style="list-style-type: none">• Ear Wax accumulation in ear canal and/or sound port• Amplifier improperly inserted	<ul style="list-style-type: none">• Clean sound port and/or have ears checked and cleaned by physician• Insert amplifier properly
“Dead” or No Sound	<ul style="list-style-type: none">• Microphone opening and/or sound port clogged with wax or moisture• Dead battery• Amplifier improperly inserted	<ul style="list-style-type: none">• Clean microphone opening and/or sound port• Replace battery• Insert amplifier properly
Intermittent Beeping	<ul style="list-style-type: none">• Weak battery	<ul style="list-style-type: none">• Replace Battery
Fades or Intermittent Sound	<ul style="list-style-type: none">• Moisture clogged microphone opening	<ul style="list-style-type: none">• Purchase and use a hearing amplifier drying kit

If you experience any problems with your hearing amplifiers contact Lucid Audio, LLC. (contact information on back) for assistance. Please do not attempt to make repairs yourself. Doing so could cause additional damage and will void any warranties.