

Better Homes & Gardens.

do it YOURSELF™

23 IDEAS
**UNDER
\$20**

ORGANIZE *your life*

18 PROJECTS
TO HELP YOU
STORE MORE

THIS WEEKEND

- + UPDATE A BATH
- + HACK CHEAP FURNITURE
- + UPGRADE YOUR OUTDOOR SPACES

ONE ROLL OF WALLPAPER, SEVEN

→ *easy* ←

PROJECTS

↑
**BUILD THIS
ENTRY BENCH**

p. 44

VOL. 27/ISSUE 4
BHG.COM/DIYMAGAZINE

DISPLAY UNTIL 10/30/20

\$7.99US \$9.99CAN



BHG SPECIALS

BOHO SLEEK

Dark and domineering give way to a light and easy vibe enhanced by minor structural changes.

WORDS **WENDY GRAY** PHOTOGRAPHS **SETH SMOOT**
STYLING **RYAN REINECK** FIELD EDITOR **KAREN REINECKE**



KYLE AND JENNIFER FINLEY'S MASTER BEDROOM WAS OPPRESSIVE, NOT REFRESHING, SO THE TWO PUT THEIR HEADS TOGETHER AND THEIR HANDS TO WORK ON A REMODEL OF THEIR 1960S RANCH HOME IN CARMICHAEL, CALIFORNIA. Building-industry professionals, the two were comfortable taking an active approach. Jennifer and Kyle did much of the work, but they turned to interior designers Leyla Jaworski and Ashlee Berry for advice on the finishes and furnishings.

Stealing a bit of square footage from the nearby playroom, the Finleys added much-needed closet space. Before the renovation, they shared a single rod behind sliding mirrored doors. Now a barn-style door does the sliding, giving the bedroom a stylish update and opening to helpful built-ins and more space for their clothes.

Working from the ground up, the designers started the shift to a brighter palette with a cheery rug that serves as a basis for the rest of the room's color scheme.

"The new light fixture we installed is made up of super-delicate shells," Jennifer says. "It lets light bounce around the room. There was a very big, very basic ceiling fan there before. Little elements like that helped us turn the space from cave-like to spa-like."

FOR RESOURCES SEE PAGE 102.



MASTER PLAN Ditching the wood four-poster in favor of smart gray upholstery, the Finleys relocated their bed to the adjacent wall and installed French doors to the backyard where there was once just a window, *opposite*. A sliding barn-style door to the walk-in closet saves floor space, *above*. The Finleys initially planned to add wainscoting to the wall behind the bed, but the designers convinced them to cover the entire wall in grid-style molding that incorporates a pair of horizontal windows into the design, *left*. "The wall behind the bed is like a giant headboard," Jennifer says. "Trimming out that window was kind of awkward for us, so this approach helped, and we were able to integrate it squarely into the pattern."

DO IT BETTER

THIS ROOM REALLY HAS LEGS. TO OPEN UP YOUR SPACE, LOOK FOR FURNITURE THAT IS ELEVATED OFF THE FLOOR. EVEN THE BENCH AT THE END OF THE BED HAS AN OPEN BOTTOM TO KEEP THE EYE MOVING.



HYDRATING A new spacious shower with two showerheads feels even larger thanks to its frameless glass enclosure, *this photo*. The Finleys were happy to sacrifice an unused makeup vanity to expand the shower. Classic white subway tile keeps the space timeless, and its affordability allowed the couple to splurge elsewhere in the bath.

IF YOUR BATHROOM IS SHORT ON SPACE, CONSIDER HOOKS INSTEAD OF TOWEL BARS. YOU'LL GET STRAIGHT-UP DRYING FUNCTIONALITY ON A SMALL WALL.





LIKE A KITCHEN SPICE RACK, THIS VERTICAL PULLOUT ADDS FUNCTION TO A SLENDER SPACE.



TOP SHELF Topping the purchased vanity with a modern vessel sink meant the Finleys could install a working drawer underneath it for additional storage.

BRIGHTEN UP

Kyle and Jennifer Finley's wooden four-poster with draperies overpowered their master bedroom. Dark colors, little natural light, and cramped closet and bath space compounded the need for an overhaul.

BEFORE

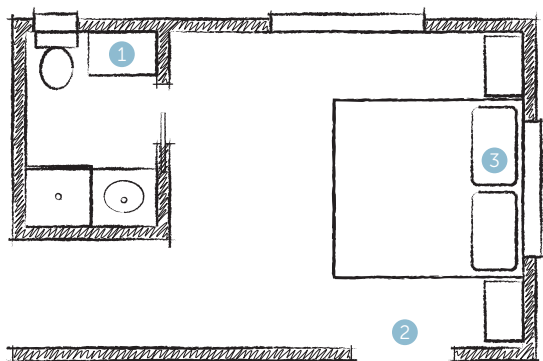

1

MAKEUP GAME
A vanity without a sink was without a purpose.

2

STORAGE WAR
With a 2-foot-deep closet, Kyle and Jennifer battled for space.

3

BLOCKADE
The bed didn't sit right in the room, blocking the window and path to the closet.

AFTER

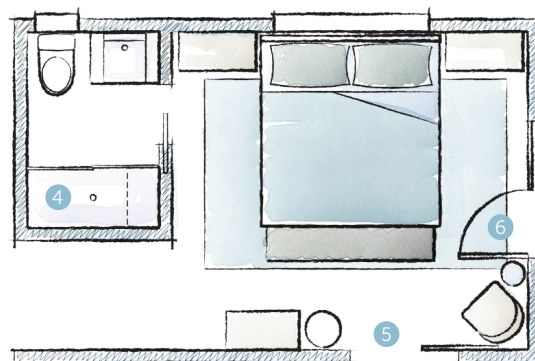

4

HAVE A SEAT
The new shower is big enough for a bench and two showerheads.

5

SACRIFICE
The kids gave up some play space for Mom and Dad's closet space.

6

THE DOORS
The Finleys now can access their backyard from their master suite.