

Following are selected screenshots from our Rep-Assisted Managed Investment Brokerage account open and enrollment flow:

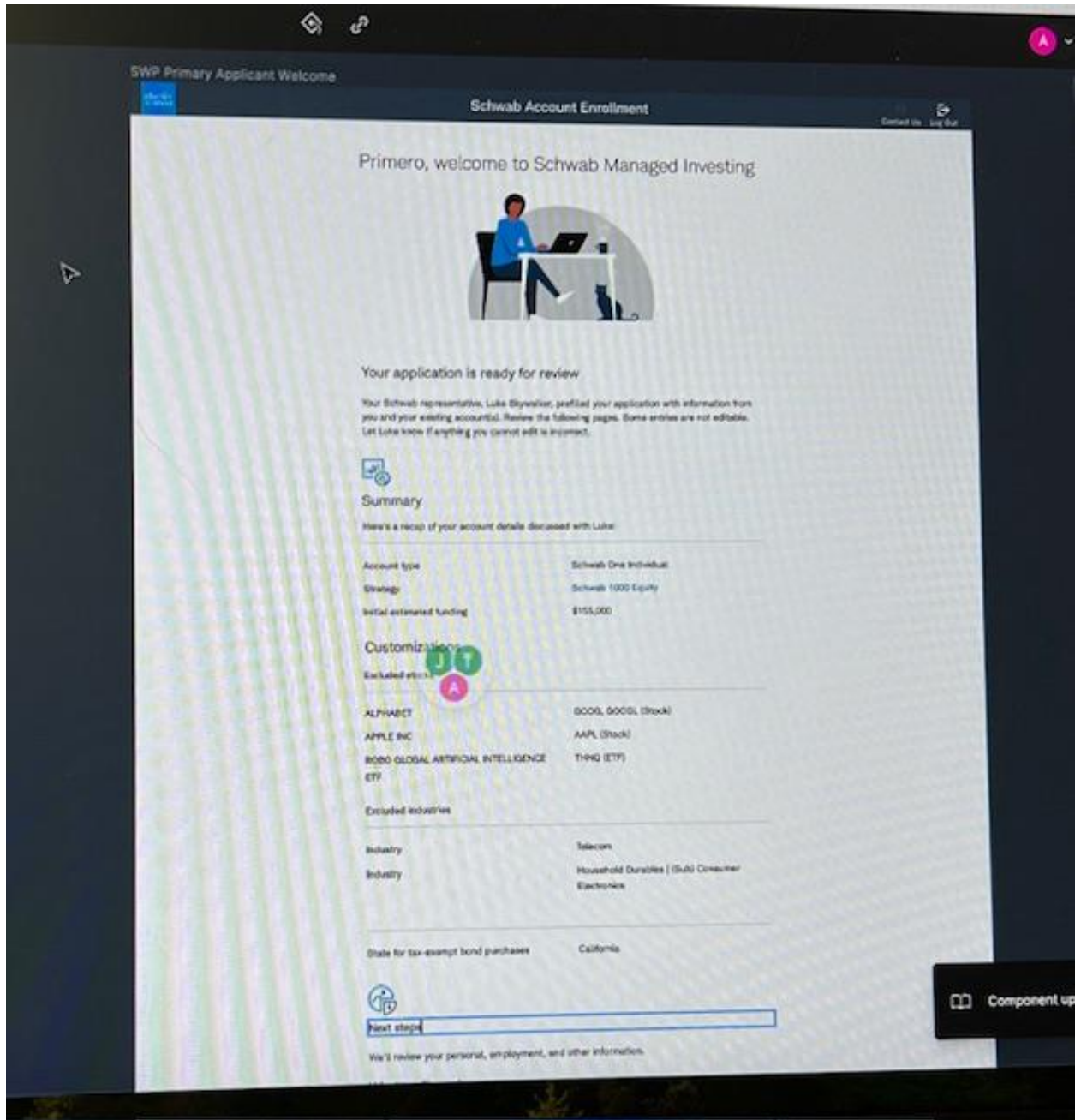

The green and pink dots represent communications back and forth with design/development/product.

Personal info page:

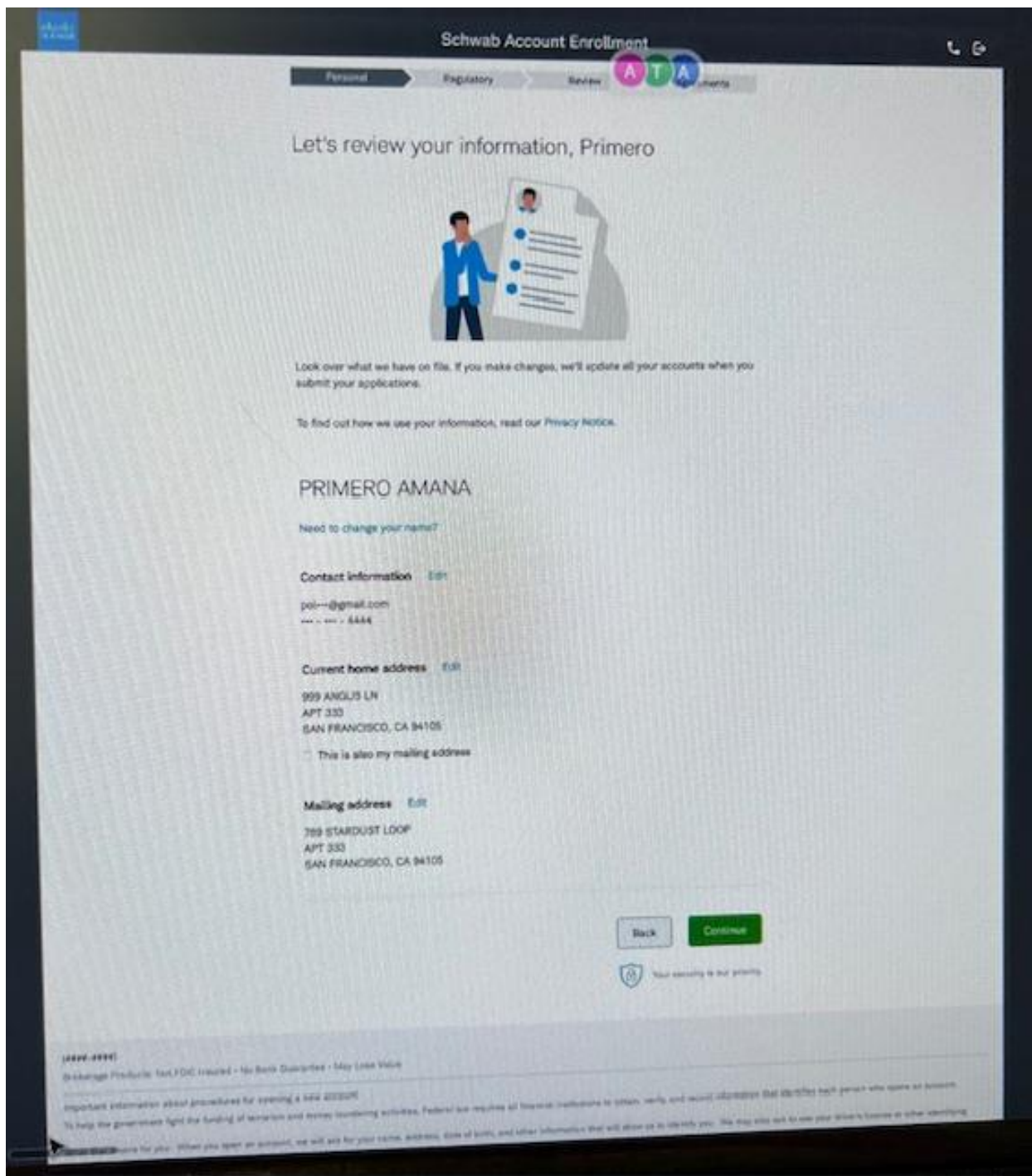

Note that we mask email and SSN.

Trusted contacts

SWP_Add_Trusted_Contact

Schwab Account Enrollment

Personal Regulatory Review Agreements

Would you like to add a Trusted Contact?

It's a good idea to name a Trusted Contact who we can contact on your behalf if we suspect you may be the target of financial exploitation or we have other concerns about your well-being. You can always add or remove a Trusted Contact after your account is opened.

What is a Trusted Contact?

Trusted Contact

A Trusted Contact must be at least 18 years old.

First name

Last name

Relationship

Where does your Trusted Contact live?

Country

Select at least one way to contact you

- Phone number
- Email
- Street address

Phone number

Email

Street address - No P.O. boxes

Street address 2 Apt, Ste, Bldg (Optional)



Purpose of account/source of funds

Why are you opening this account?



On the next few pages, we need to collect information to comply with regulations. Like pre-filled the following information. However, you can change it if needed. When everything looks good, continue to the next screen.

Investing purpose and source of funds

Why are you opening a brokerage account? Select all that apply:

- General purposes
- Estate planning
- Tax planning
- College
- Retirement
- Pooled assets
- Other purpose

What are the sources of funds for your brokerage account? Select all that apply:

- Salary, wages, or savings
- Social Security benefits
- Sale of property or business
- Family, relatives, or inheritance
- Investment capital gains
- Gifts
- Gambling or lottery
- Other source of funds

Back Continue

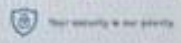

Regulatory:

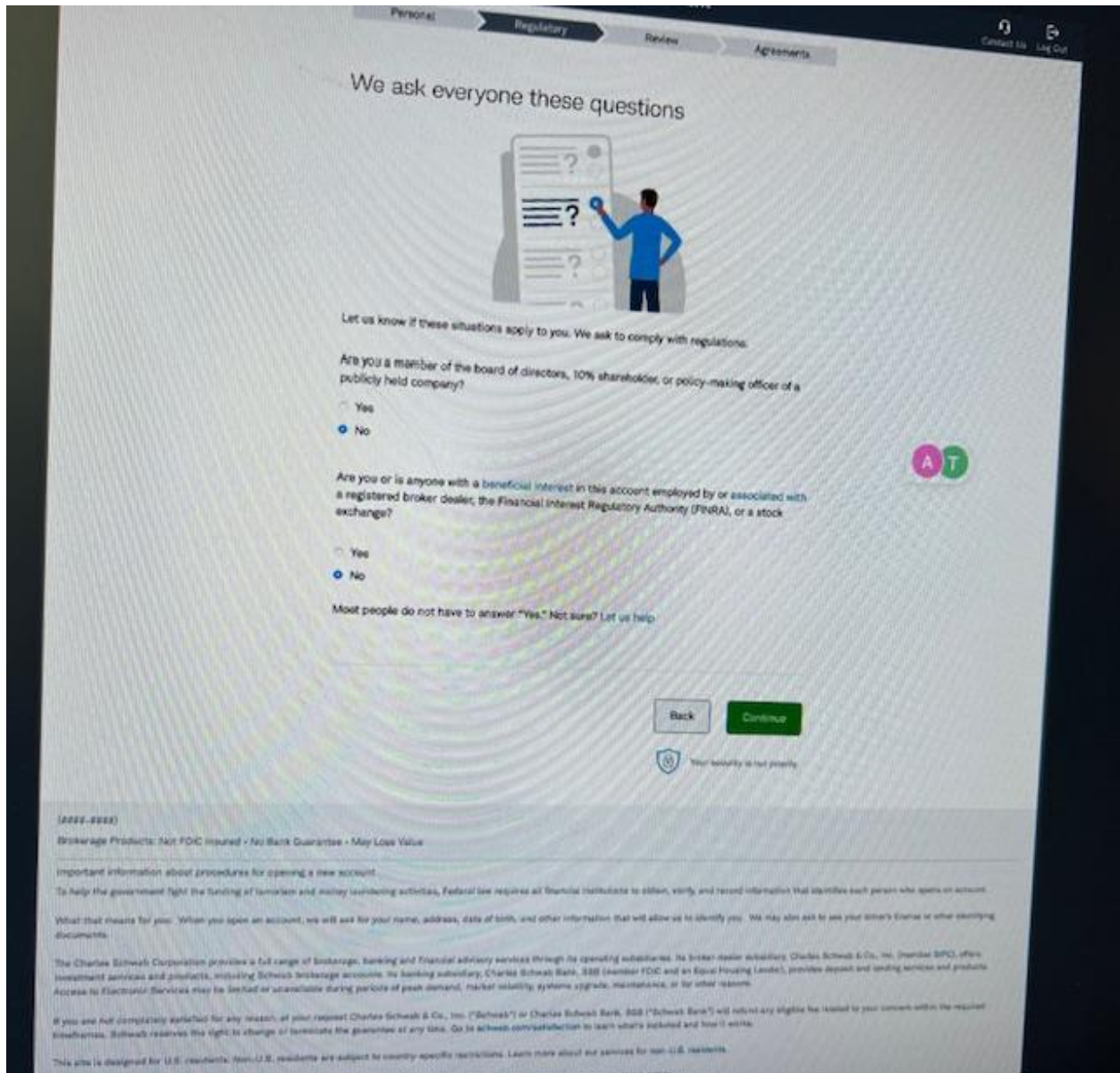

Confirmation – success

Congratulations, Primero, your account is now open



Your **Schwab One Individual Brokerage** account is open and ready to fund. Your account number is 1234-5678.

What's next?

Luke or another Schwab representative will contact you to discuss and review funding. We'll notify you once funding is complete.

What to do while you wait

[Review account settings](#)

[Explore Schwab resources](#)



We care about our relationship with you.
See our client relationship summaries.

(www.schwab.com)

Brokerage Products Not FDIC Insured • No Bank Guarantee • May Lose Value

Important information about procedures for opening a new account

To help the government fight the funding of terrorism and money laundering activities, Federal law requires all financial institutions to obtain, verify, and record information that identifies each person who opens an account.

What that means for you: When you open an account, we will ask for your name, address, date of birth, and other information that will allow us to identify you. We may also ask to see your driver's license or other identifying documents.

The Charles Schwab Corporation provides a full range of brokerage, banking and financial advisory services through its operating subsidiaries. Its broker-dealer subsidiary, Charles Schwab & Co., Inc. (Member SIPC), offers investment services and products, including Schwab brokerage accounts. Its banking subsidiary, Charles Schwab Bank, SSB (Member FDIC and an Equal Housing Lender), provides deposit and lending services and products. Access to Electronic Services may be limited or unavailable during periods of peak demand, market volatility, systems upgrade, maintenance, or for other reasons.

If you are not completely satisfied for any reason, at your request Charles Schwab & Co., Inc. ("Schwab") or Charles Schwab Bank, SSB ("Schwab Bank") will refund any eligible fee related to your account within the required timeframes. Schwab reserves the right to change or terminate the guarantee at any time. Go to schwab.com/applifeactor to learn what's included and how it works.

This site is designed for U.S. residents. Non-U.S. residents are subject to country-specific restrictions. Learn more about our services for non-U.S. residents.

© 2022 Charles Schwab & Co., Inc. All rights reserved. Member SIPC. Unauthorized access is prohibited. Usage will be monitored. (0719-5218)

Privacy | SchwabSafe | Contact Us | Do Not Sell or Share My Personal Information

Confirmation – regulatory or other review

You've completed your application, Primero



1

Now it's up to us to approve your Schwab One® Brokerage account. The review usually takes a few days.

What's next?

Once the account is opened, Luke or another Schwab representative will contact you to discuss and review funding. We'll let you know once funding is complete.

What to do while you wait

[Review account settings](#)

[Explore Schwab resources](#)



Your security is our priority.

(888) 234-2344

Brokerage Products Not FDIC Insured • No Bank Guarantee • May Lose Value

The Charles Schwab Corporation provides a full range of brokerage, banking and financial advisory services through its operating subsidiaries. Its broker-dealer subsidiary, Charles Schwab & Co., Inc. (Member SIPC), offers investment services and products, including Schwab brokerage accounts. Its banking subsidiary, Charles Schwab Bank, SSB (Member FDIC and an Equal Housing Lender), provides deposit and lending services and products. Access to Electronic Services may be limited or unavailable during periods of peak demand, market volatility, systems upgrade, maintenance, or for other reasons.

This site is designed for U.S. residents. Non-U.S. residents are subject to country-specific restrictions. Learn more about our services for non-U.S. residents.

© 2011 Charles Schwab & Co., Inc. All rights reserved. Member SIPC. Unauthorized access is prohibited. Usage will be monitored.

(888) 234-2344

[Privacy](#) | [SchwabSafe](#) | [Contact Us](#)