

08 - EIGHTH FLOOR NET USABLE BREAKDOWN

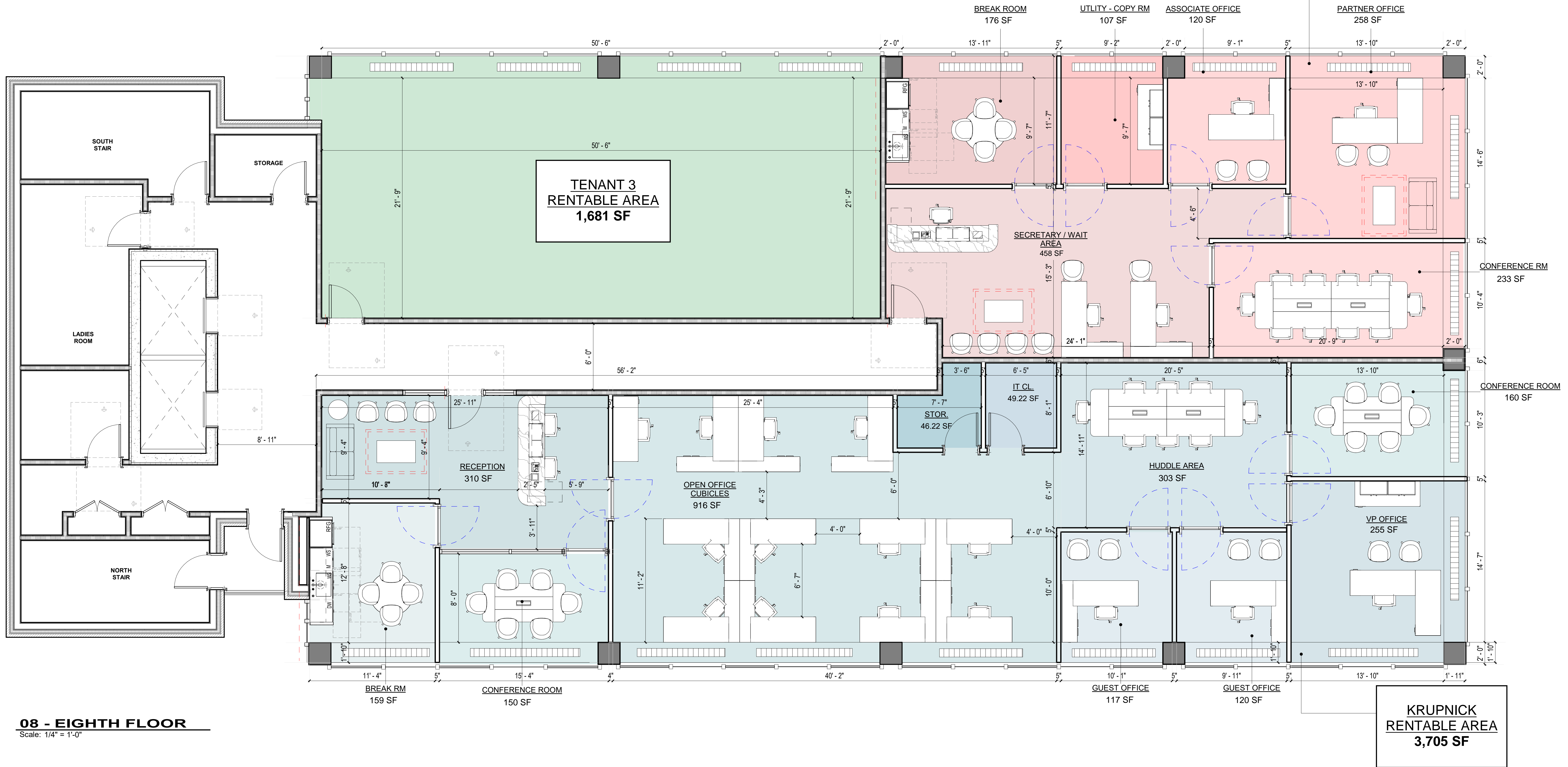

**08 - EIGHTH FLOOR**  
Scale: 1/4" = 1'-0"

Architecture  
Interior Design  
Code Consultant  
Building Dept.  
Expediting

**Gerald J. Caliendo, R.A., A.I.A.**  
Architect, P.C.

138-72 Queens Boulevard  
Briarwood N.Y. 11435

Tel: (718) 268-9098  
Fax: (718) 268-9097  
www.caliendoarchitects.com

KEY PLAN:

CONSULTANTS:

OWNER:  
CORD MEYER

DRAWING TITLE: **008 FLOOR PLAN**

PROJECT ADDRESS:  
**EXISTING OFFICE BUILDING  
108-18 QUEENS BLVD  
FOREST HILLS, NEW YORK**

No.	Date	Description

SEAL:  
DOB APPROVAL:

DOB: **123**

DRAWING No.:      OF 116

**A-114 00**

THE ARCHITECT SHALL NOT HAVE CONTROL OR CHARGE OF AND SHALL NOT BE RESPONSIBLE FOR CONSTRUCTION MEANS, METHODS, DEVIATIONS, OR PROCEDURES OR FOR SAFETY PRECAUTIONS AND PROGRAMS IN CONNECTIONS WITH THE WORK, FOR THE ACTS OR OMISSIONS OF THE CONTRACTOR, SUBCONTRACTORS OR ANY OTHER PERSONS PERFORMING ANY OF THE WORK, OR FOR THE FAILURE OF THEM TO CARRY OUT THE WORK IN ACCORDANCE WITH THE CONTRACT DOCUMENTS. ALWAYS USE DIMENSIONS AS SHOWN. DRAWINGS ARE NOT TO BE SCALED. GERALD J. CALIENDO ARCHITECT, P.C. AND ITS PRINCIPAL EMPLOYEES WERE NOT RETAINED FOR ANY CONSTRUCTION SUPERVISION.







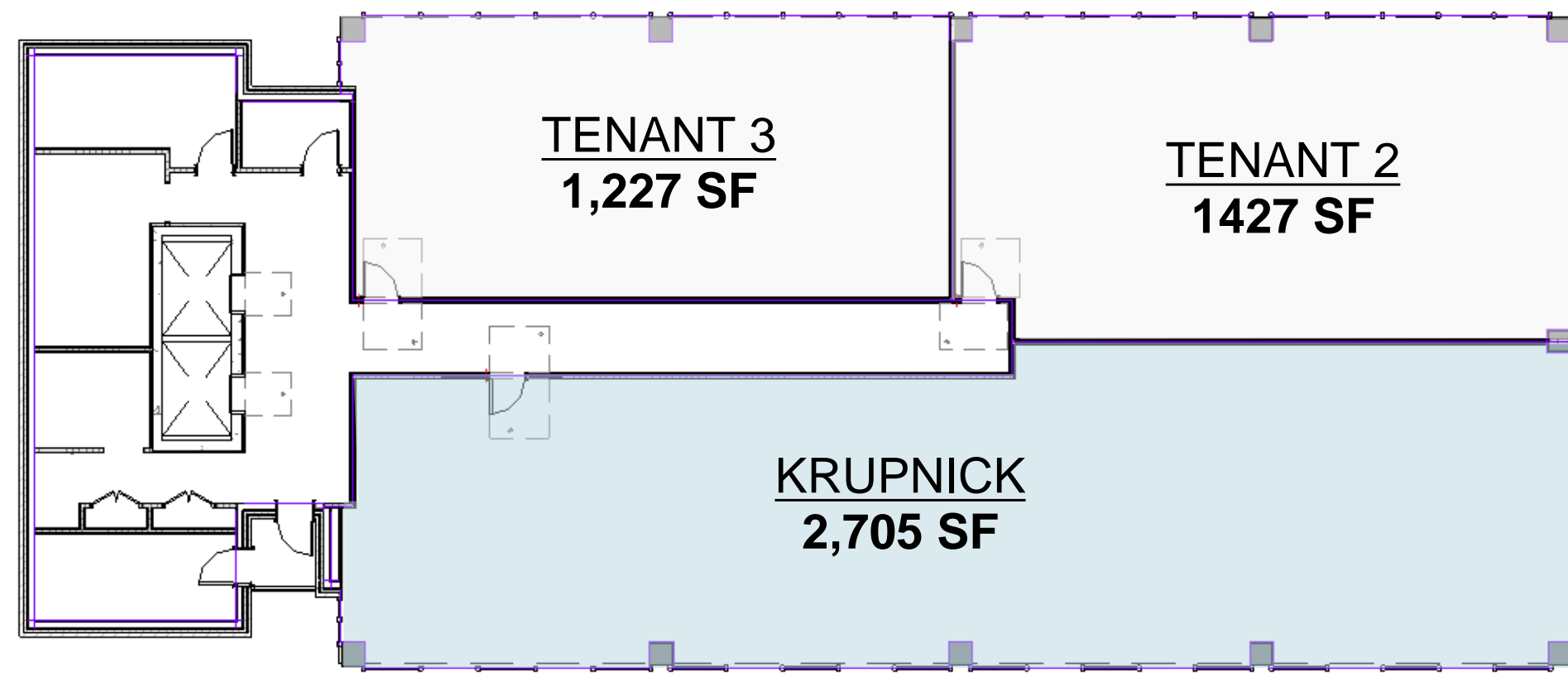

08 - EIGHTH FLOOR NET USABLE BREAKDOWN



**08 - EIGHTH FLOOR**

Scale: 1/4" = 1'-0"

**LAYOUT FOR KRUPNICK LAW OFFICES**

USABLE AREA = **2,705 SF**  
 NET RENTABLE = **3,705 SF**

Architecture  
 Interior Design  
 Code Consultant  
 Building Dept.  
 Expediting

**Gerald J. Caliendo, R.A., A.I.A.**  
 Architect, P.C.

138-72 Queens Boulevard  
 Briarwood N.Y. 11435  
 Tel. (718) 268-9098  
 Fax (718) 268-9097  
 www.caliendoarchitects.com

KEY PLAN:

CONSULTANTS:

OWNER:  
**CORD MEYER**

DRAWING TITLE:  
**008 FLOOR PLAN**

PROJECT ADDRESS:  
**EXISTING OFFICE BUILDING  
 108-18 QUEENS BLVD  
 FOREST HILLS, NEW YORK**

No.	Date	Description

SEAL:  
 DOB APPROVAL:

DOB: **123**  
 DRAWING No.:      OF 116

**A-114 00**

THE ARCHITECT SHALL NOT HAVE CONTROL OR CHARGE OF AND SHALL NOT BE RESPONSIBLE FOR CONSTRUCTION MEANS, METHODS, DEVIATIONS, OR PROCEDURES OR FOR SAFETY PRECAUTIONS AND PROGRAMS IN CONNECTIONS WITH THE WORK, FOR THE ACTS OR OMISSIONS OF THE CONTRACTOR, SUBCONTRACTORS OR ANY OTHER PERSONS PERFORMING ANY OF THE WORK, OR FOR THE FAILURE OF THEM TO CARRY OUT THE WORK IN ACCORDANCE WITH THE CONTRACT DOCUMENTS. ALWAYS USE DIMENSIONS AS SHOWN. DRAWINGS ARE NOT TO BE SCALED. GERALD J. CALIENDO ARCHITECT, P.C. AND ITS PRINCIPAL EMPLOYEES WERE NOT RETAINED FOR ANY CONSTRUCTION SUPERVISION.

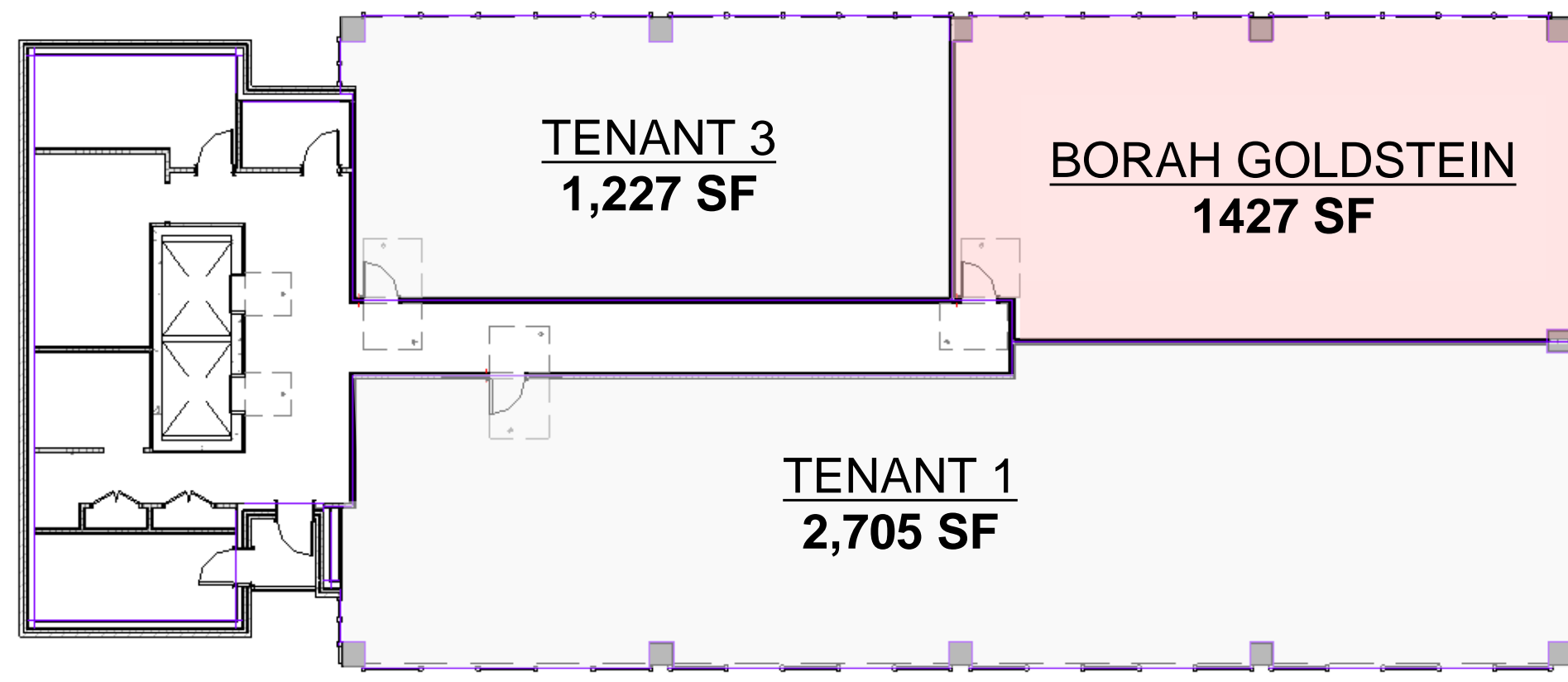

**08 - EIGHTH FLOOR NET USABLE BREAKDOWN**

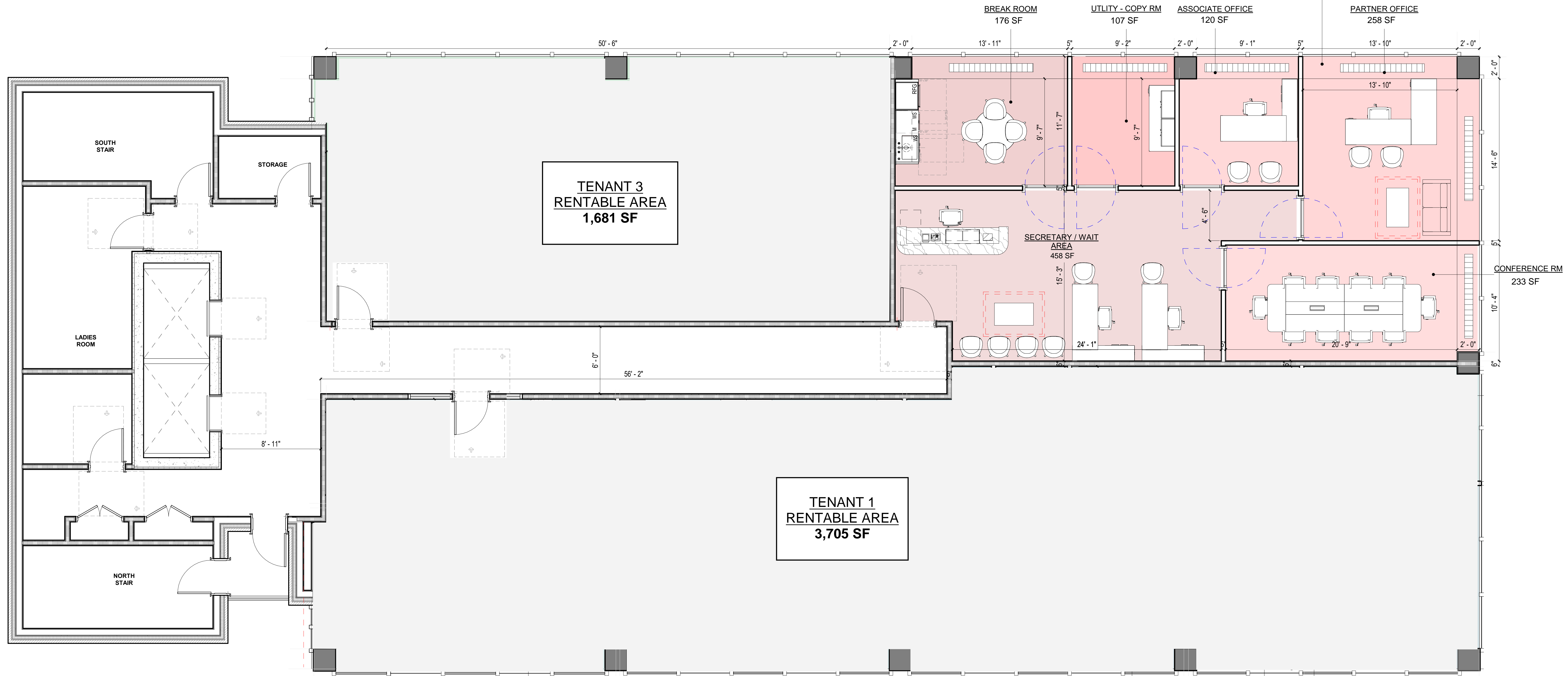

**08 - EIGHTH FLOOR**

Scale: 1/4" = 1'-0"

**LAYOUT FOR BORAH GOLDSTEIN..**

**GROSS AREA = 1,427 SF**  
**NET RENTABLE = 1,955 SF**



CONSULTANTS:

OWNER:  
CORD MEYER

DRAWING TITLE: **008 FLOOR PLAN**

PROJECT ADDRESS: **EXISTING OFFICE BUILDING  
108-18 QUEENS BLVD  
FOREST HILLS, NEW YORK**

No.	Date	Description

SEAL:  
DOB APPROVAL:

THE ARCHITECT SHALL NOT HAVE CONTROL OR CHARGE OF AND SHALL NOT BE RESPONSIBLE FOR CONSTRUCTION MEANS, METHODS, DEVIATIONS, OR PROCEDURES, OR FOR SAFETY PRECAUTIONS AND PROGRAMS IN CONNECTIONS WITH THE WORK, FOR THE ACTS OR OMISSIONS OF THE CONTRACTOR, SUBCONTRACTORS OR ANY OTHER PERSONS PERFORMING ANY OF THE WORK, OR FOR THE FAILURE OF THEM TO CARRY OUT THE WORK IN ACCORDANCE WITH THE CONTRACT DOCUMENTS. ALWAYS USE DIMENSIONS AS SHOWN. DRAWINGS ARE NOT TO BE SCALED. GERALD J. CALIENDO ARCHITECT, P.C. AND ITS PRINCIPAL EMPLOYEES WERE NOT RETAINED FOR ANY CONSTRUCTION SUPERVISION.