

HÖUM®



Gard Inc. Sdn. Bhd.

No. 13, Jalan Budiman,
Budiman Business Park,
Bandar Sungai Long,
43000 Kajang,
Selangor, Malaysia.

+603 8741 7300

+603 8689 8018

support@gardinc.com

facebook.com/hoummalaysia

houm.asia

instagram.com/houm.asia

V.22.1



* Terms and Conditions Apply

HÖUM® VENTILATION

Breathe in Quality Air at Home



ABOUT **HÖUM**®

The HÖUM® brand is the third brainchild of Gard Inc. Sdn. Bhd. and is reputed for outstanding innovations. Established in 2001, our initial venture into the industrial and commercial sectors was then expanded into the domestic segment in 2015. HÖUM® specializes in delivering consumer electronics and home solutions of excellent standards. We offer modern living products designed and engineered to complement the lifestyle of today's people.

HÖUM®'s combination of appealing visuals and contemporary functionality brings new life into a home's atmosphere whilst ensuring a minimal environmental footprint. Consumers remain the heart of our brand and the driving force in our efforts to product quality solutions and innovations. Home transformations are possible and simple with our sleek and compact products.

SPECIFICATION & DIMENSION



Model	GE-150	GE-250	DE-180	DE-450	SV-90
Motor Type	Shaded Pole	Shaded Pole	Bell Bearing	Bell Bearing	Turbine Motor
Power Wattage (W)	15	25	24	38	28
Voltage (V/Hz)	220-240 ; 50Hz	220-240 ; 50Hz	220-240 ; 50Hz	220-240 ; 50Hz	220-240 ; 50Hz
IP Class	IPX0; T45	IPX0; T45	IPX0; T45	IPX0; T45	IPX0; T45
Motor Speed (RPM)	1,950	1,800	1,300	1,200	1,080
Air Flow (CFM)	150	250	180	450	90
Noise Level (dB)	40	43	40	45	39
Duct Size (MM)	-	-	-	-	100 (4")
Front Panel (MM)	208	268	245 x 245	345 x 345	268 x 268
Mounting Hole Size (MM)	177	238	193 x 193	290 x 290	227 x 227
Product Weight (KG)	0.54	0.885	1.32	1.98	1.39
Installation Type	Glass Mounted	Glass Mounted	Wall Mounted	Wall Mounted	Ceiling Mounted

IN COMPLIANCE WITH:





GE-150



GE-250

GLASS MOUNTED VENTILATION FAN

This energy saving Glass Mounted Ventilation Fan features a strong dynamic and thermal stability that leads to a longer product lifespan thanks to the high performance copper winding motor. Plus, the cord operated flexi back shutter allows for flexible operation and features a high conductivity copper which makes it structurally safe in high temperatures.

FEATURES



HIGH PERFORMANCE
COPPER WINDING
MOTOR



STRONG ANTI
SHORT-CIRCUIT
ABILITY



FLEXI BACK
SHUTTER



ENERGY SAVING



EASY
INSTALLATION

MODEL	GE-150	GE-250
Air Flow (CFM)	150	250
Noise Level (dB)	40	43
Mounting Hole Size	177	238

MODEL	GE-150	GE-250
A	160	210
B	210	270
C	65	80
D	39	41
E	28	40
F	38	40
G	177	238
H	165	228

Measurements in millimeters

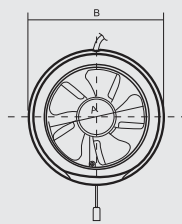

FRONT VIEW

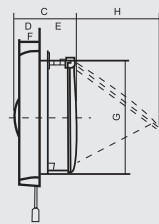

SIDE VIEW



This Glass Mounted Ventilation Fan is best suited for washrooms.



DE-180



DE-450

WALL MOUNTED VENTILATION FAN

Featuring the first ever Dual Airflow Wall Mounted Ventilation Fan in Malaysia; best suited for kitchens, washrooms, and even altar rooms for optimum air dilution. Improving indoor air ventilation is vital in our homes today to battle Covid-19 and other airborne diseases by keeping virus particles from accumulating indoors. It also has a high-quality, reputable NSK/NMB ball bearing fitted for 10 times the lifespan of a typical oil bearing.

FEATURES



HIGH PERFORMANCE
COPPER WINDING
MOTOR



STRONG ANTI
SHORT-CIRCUIT
ABILITY



DUAL AIRFLOW
OPERATION



ENERGY SAVING



NSK / NMB
HIGH QUALITY
BALL BEARING

MODEL	DE-180	DE-450
Air Flow (CFM)	180	450
Noise Level (dB)	40	45
Mounting Hole Size	193 x 193	290 x 290



DUAL AIRFLOW VENTILATION FAN HIGHLIGHTS



EXHAUST OUTWARD

On default operation, the fan will exhaust outward, drawing air outside, and clearing bad odors and humidity.

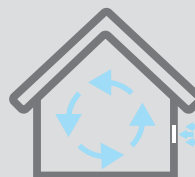

REVERSIBLE FLOW

The fan runs in reverse and blows inwards, promoting the circulation of fresh air.

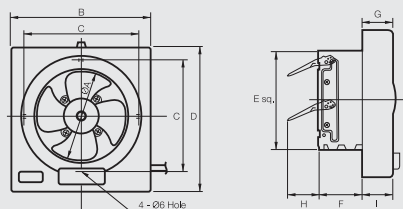

FRONT VIEW

SIDE VIEW

MODEL	DE-180	DE-450
A	160	270
B	254	343
C	210	323
D	225	343
E	193 x 193	290 x 290
F	77	75
G	30	30
H	45	65

Measurements in millimeters



SV-90 (D1)



SV-90 (D2)

CEILING MOUNTED VENTILATION FAN

This aesthetically pleasing Ceiling Mounted Ventilation Fan features a turbine fan motor that effectively produces high static pressure in enclosures and an energy efficient build. It also has a high-quality, reputable NSK/NMB ball bearing fitted for 10 times the lifespan of a typical oil bearing. Plus, it features an amazing silent operation that reduces noise pollution in your home.

FEATURES



TURBINE FAN
MOTOR



AESTHETICALLY
BEAUTIFUL



SILENT
OPERATION



HIGH STATIC
PRESSURE



NSK / NMB
HIGH QUALITY
BALL BEARING

MODEL	SV-90
Motor Type	Turbine
Air Flow (CFM)	90
Noise Level (dB)	39
Mounting Hole Size	227 x 227

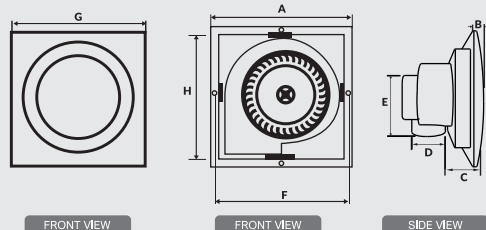

MODEL	SV-90
A	267
B	18
C	58
D	98
E	204
F	245
G	270
H	227

Measurements in millimeters



This Ceiling Mounted Ventilation Fan can suit any aesthetic and space in your home.