

Safety First

Though Netbundy is generally safe to use, kindly follow the instructions and read the warnings to avoid any mishaps.

“Unboxing”

What you'll find inside the package:

- Netbundy device
- Power cord
- Charger
- Our sincere gratitude



To reduce or avoid unwanted incidents of electric shock, fire, or explosions, do not disassemble, stick in the microwave, cook, expose to molten lava or extreme heat, plug in unauthorized devices or batteries, place near combustible items, stab through, splash or submerge in corrosive liquid, crush under heavy weights, and use to deflect laser blasts or kamehameha waves.

UNFOLD TO SEE INSTRUCTIONS

Choose your path

This is my first Netbundy Experience

Already have a Netbundy, show me how to link my new device

Turn on the device and connect to the WiFi or mobile data.

**I am a New Customer,
Register my Company**

Turn on the device and connect to the WiFi or mobile data.

**I am an existing Customer,
Link my Device(s) to my Company**

Click on the **Register my Company** option

Click on the **Link this Device** option

In the Register my Company screen, enter your company name in the Company Name field and your email address in the Email address field. Click on Register.

In the Link this Device Screen, link your device through any of the following options:

In the Choose Security Model, choose your security preference:

Enhanced Security (DEFAULT)

Added layer of security upon fingerprint registration and verification

Basic Security

Quicker fingerprint registration and verification

Link with my Account

Tap on the Link with my account. After tapping on it, the Company Credentials screen appears.

Scan QR Code to Link Device

Tap on the icon on top of the Scan QR Code to Link Device. After tapping on it, the back camera activates.

In the Welcome screen, click on the **Get Started**

Fill out the Company ID and Enter your PIN fields. (See your first email from support@upraxis.com). Click on the **Link Device**.

Align the camera with the QR code that was sent to your first email from support@upraxis.com. After verification, the welcome page appears. Click on **Get Started** to continue.

In your PC, laptop, or mobile, check the Inbox of your enrolled email account and look for an email from support@upraxis.com. Open and take note of the credentials.



Netbundy

Biometric Time and Attendance Device



QUICK START GUIDE

Please read this manual carefully before operating your device.

NEED SUPPORT?

Drop us a message at support@netbundy.com

<https://netbundy.com>

Product Specification

Dimension: 235(L)×147(W)×28(H)mm
 Camera: front (2MP), back (8MP)
 Weight: 780g
 Working frequency: 13.56MHz±7KHZ
 Power: Battery - Standard: 3.7V, 6000mAh
 Fingerprint: Authentication type: 1:1, 1:N
 Certifications: CE, RoHS, FCC, ISO9001
 Panel: Capacitive Screen
 WIFI: 802.11 b/g/n
 CPU: Quad-core up to 1.3Ghz

Legend

1 Power button
 2 2MP front camera
 3 8MP rear camera
 4 Fingerprint scanner
 5 Card scanner
 6 Reset button
 7 Charger port

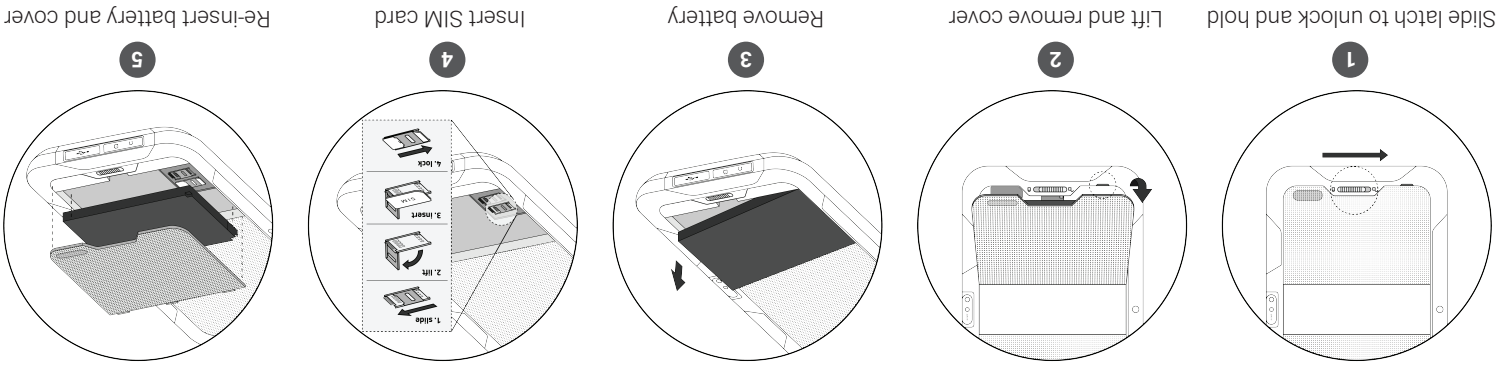
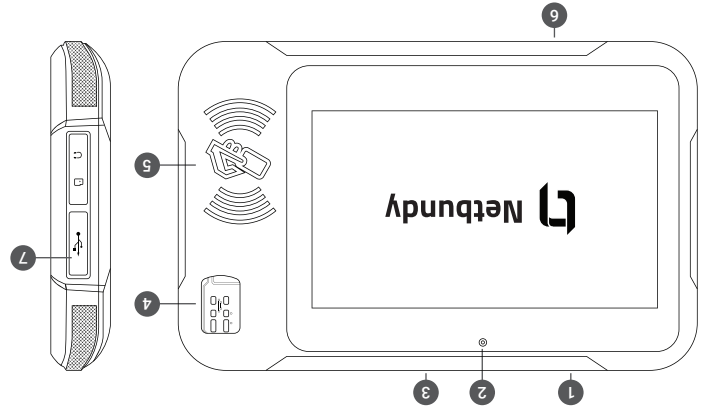

How to Insert your SIM Card for Mobile Data (THE DEVICE MUST BE TURNED OFF)

- Keep the Device away from direct sunlight, moisture, and objects that emits substantial amount of heat, electrical magnetic pulse, and vibration.
- Ensure the cleanliness of the Device from dirt, liquid, and other products that may corrode it. Use only lint free scratch resistant cloth that is lightly moistened if necessary.
- Reboot/Reset the device every two days.
- Allow the Device to accept and complete the system updates from JustPayroll or PhilPay.
- Avoid dropping, hitting, heavily pressing down, tampering, scratching, and other activities that instill damage on the Device.
- Avoid overcharging the Device.
- Allow the Device to cool by shutting it down if it gets hot.

Tips on Product Care